

# Technical data sheet



## Product features

### Cooking range electric 2x plate on open cabinet 400 V

<b>Model</b>	<b>SAP Code</b>	00110098
--------------	-----------------	----------



- Device type: Electric unit
- Power consumption of the zone 1 [kW]: 2x hotplates 2.6 kW ø 220 mm
- Power consumption of the zone 2 [kW]: 2,6
- Protection of controls: IPX4
- Material: AISI 304 top plate, AISI 430 cladding

<b>SAP Code</b>	00110098	<b>Loading</b>	400 V / 3N - 50 Hz
<b>Net Width [mm]</b>	400	<b>Number of zones</b>	2
<b>Net Depth [mm]</b>	700	<b>Power consumption of the zone 1 [kW]</b>	2x hotplates 2.6 kW ø 220 mm
<b>Net Height [mm]</b>	900	<b>Power consumption of the zone 2 [kW]</b>	2,6
<b>Net Weight [kg]</b>	32.00	<b>Diameter of device [mm]</b>	220
<b>Power electric [kW]</b>	5.200		

# Technical data sheet



Technical drawing

Cooking range electric 2x plate on open cabinet 400 V

Model

SAP Code

00110098

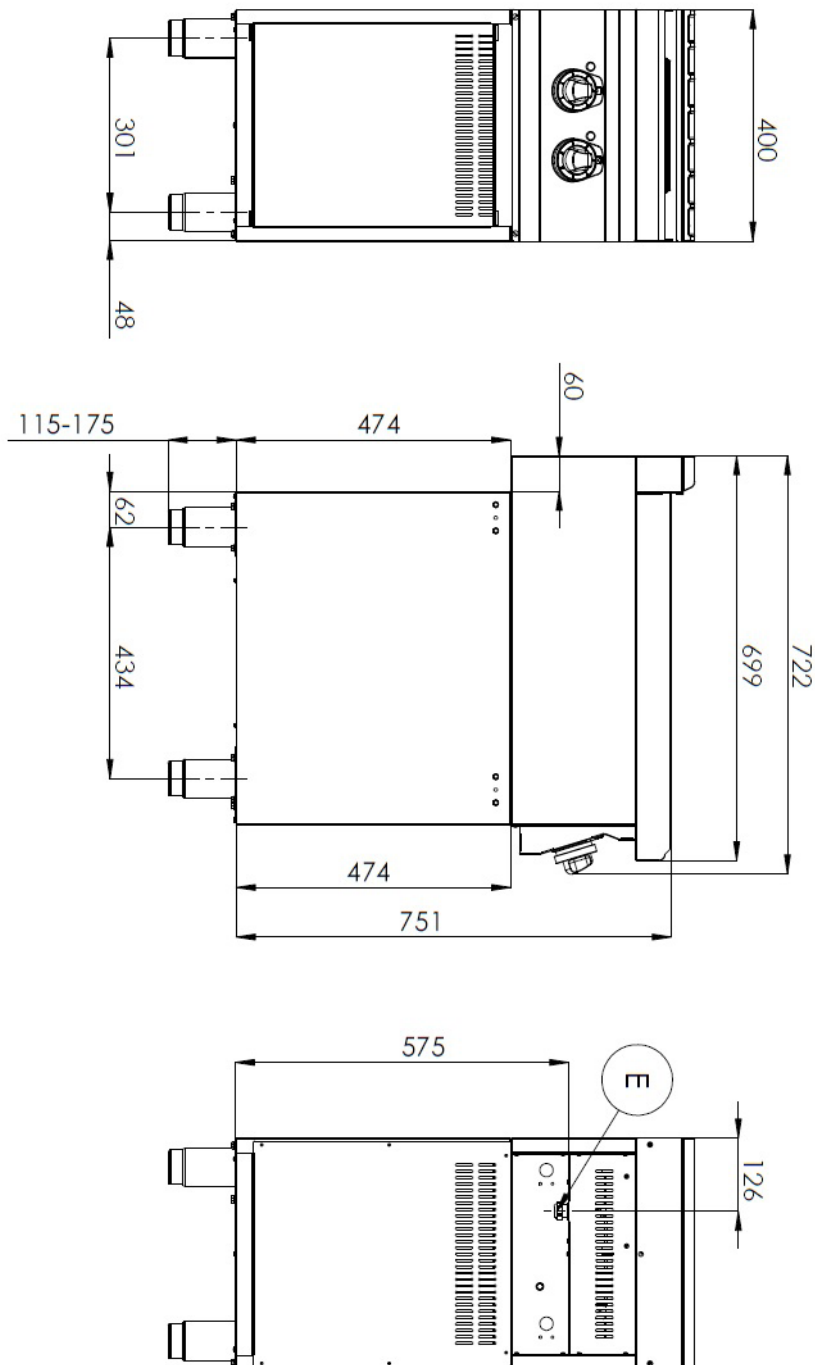

### Cooking range electric 2x plate on open cabinet 400 V

Model

SAP Code

00110098

1

#### Round plates

quick warm-up  
efficient cooking on a round surface with easy  
adhesion to dishes

- time-saving in food preparation
- easy to use thanks to the large surface area of the  
cooking plates

2

#### Internal thermostatic plate protection

longer service life of the plates

- no overheating of the plates and no cracking

3

#### Degree of protection of the control elements IPX4

maintenance-free system  
resistance to splash water  
long life

- savings on service interventions
- easy cleaning and maintenance of equipment

4

#### All-stainless design

long life  
resistance of a ground steel plate with  
a thickness of 10 mm

- savings on service interventions
- higher corrosion resistance

5

#### Hygienic moldings of the top plate

absence of sharp corners and edges (potential places  
where dirt could stick)  
smooth transitions

- easy quick cleaning

6

#### Variability

the possibility of adding to the current line  
easy possibility of creating one module  
long life

- cost saving
- space saving
- long service life

# Technical data sheet



## Technical parameters

### Cooking range electric 2x plate on open cabinet 400 V

<b>Model</b>	<b>SAP Code</b>	00110098
--------------	-----------------	----------

**1. SAP Code:**

00110098

**2. Net Width [mm]:**

400

**3. Net Depth [mm]:**

700

**4. Net Height [mm]:**

900

**5. Net Weight [kg]:**

32.00

**6. Gross Width [mm]:**

440

**7. Gross depth [mm]:**

800

**8. Gross Height [mm]:**

975

**9. Gross Weight [kg]:**

40.00

**10. Device type:**

Electric unit

**11. Construction type of device:**

With substructure

**12. Power electric [kW]:**

5.200

**13. Loading:**

400 V / 3N - 50 Hz

**14. Protection of controls:**

IPX4

**15. Material:**

AISI 304 top plate, AISI 430 cladding

**16. Worktop type:**

Molded - comfortable cleaning maintenance

**17. Worktop material:**

AISI 304

**18. Worktop Thickness [mm]:**

1.20

**19. Number of zones:**

2

**20. Power consumption of the zone 1 [kW]:**

2x hotplates 2.6 kW ø 220 mm

**21. Power consumption of the zone 2 [kW]:**

2,6

**22. Number of power control stages:**

6

**23. Service accessibility:**

Trough the frontal panel

**24. Safety element:**

internal thermostatic protection of the hotplate against overheating

**25. Adjustable feet:**

Yes

**26. Number of burners/hot plates:**

2

**27. Diameter of device [mm]:**

220

**28. Type of electric cooking zones:**

Oval